

MASTER SITE DEVELOPMENT PLAN

SCALE: GRAPHIC
 0' 100' 250' 500'



NOTE:

THIS CONCEPTUAL SITE PLAN IS FOR MARKETING PURPOSES ONLY, AND HAS BEEN PREPARED FOR CLIENT BASED UPON PRELIMINARY AVAILABLE SITE INFORMATION DEEMED RELIABLE. ALL DIMENSIONS, GRADES AND AREA CALCULATIONS ARE SUBJECT TO VERIFICATION AND MODIFICATION BY A PROFESSIONAL CIVIL ENGINEER FOR COMPLIANCE WITH ALL NATIONAL, STATE, AND LOCAL REGULATIONS. NOT FOR REGULATORY APPROVAL, PERMITTING, OR CONSTRUCTION.

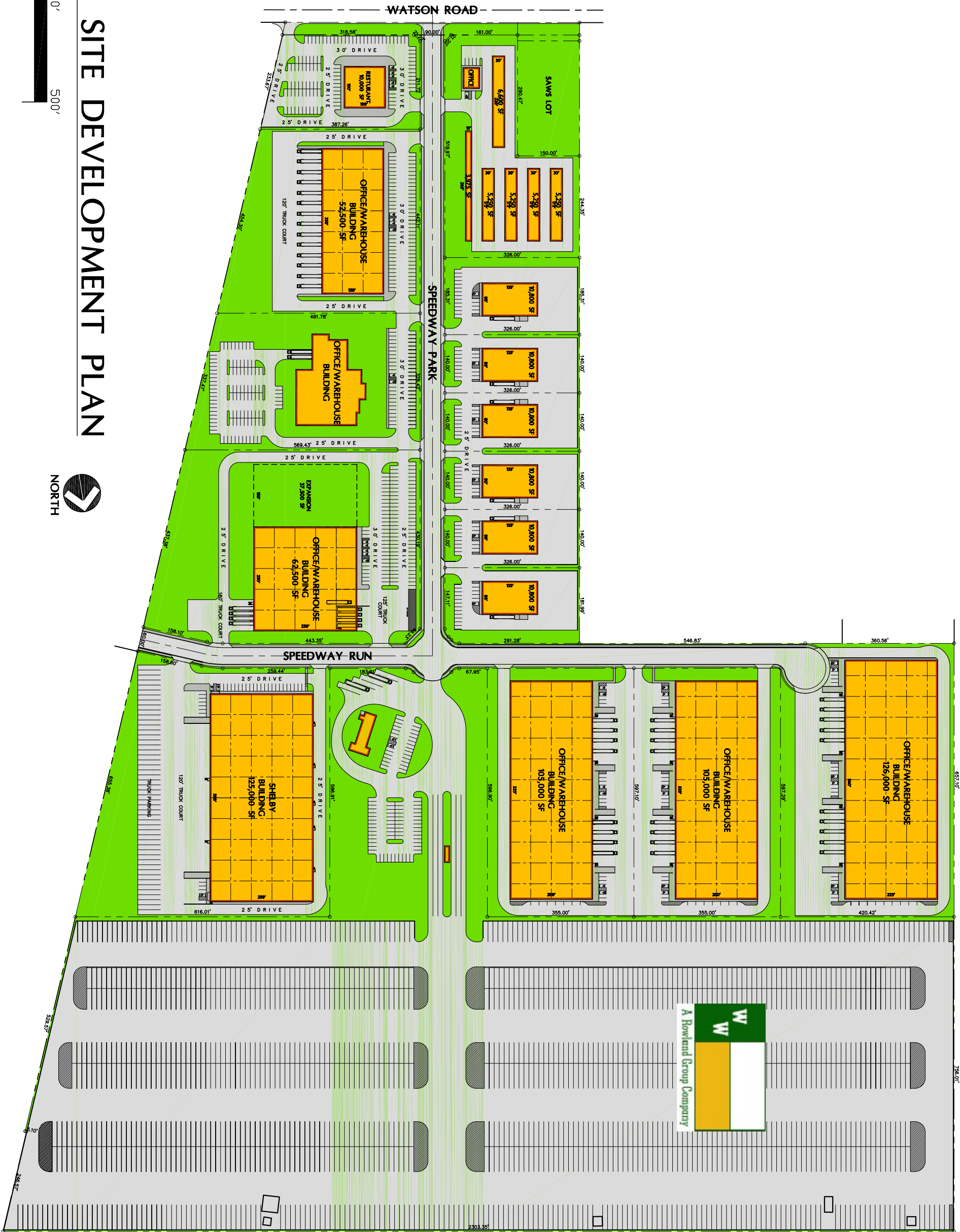

SP1-0922209

<p>MASTER SITE DEVELOPMENT PLAN</p> <p>SPEEDWAY BUSINESS PARK SAN ANTONIO, TEXAS</p>		<p>DAW DEVELOPMENT, LLC</p> <p>P.O. Box 831501 San Antonio, TX 78283 office: 210.628.1159 cell: 210.557.2447 dwittschibe@gtc.com</p>	
--	--	--	--

<h1>SP1</h1>	DRAWN	JRF
	CHECKED	JRF
	DATE	09/22/09
	PROJECT	SPEEDWAY BUSINESS
	JOB NO.	09-119
	SHEET	