

**NOTES:**

- FULL HGT. ONE HOUR FIRE RATED DIVISIVE PARTITION. CONSTRUCTED USING:  
3 5/8" 20 GAUGE METAL STUDS AT 16" O.C. WITH ONE LAYER OF 5/8" THICK TYPE "X" GYPSUM WALL BOARD ON EACH SIDE TAPE/FLOAT ALL JOINTS.
- CONTRACTOR SHALL CONSTRUCT A STEEL REINFORCED CONCRETE RAMP FROM EXISTING PAVING UP TO FINISHED FLOOR LEVEL. RAMP SHALL BE CONSTRUCTED WITH 6" WIDE x 6" HIGH CONCRETE CURBS ALONG OUTER EDGES OF RAMP SURFACE.
- REPLACE EXISTING OVERHEAD DOOR WITH A NEW ALUMINUM & GLASS STOREFRONT (TO MATCH EXISTING BLDG. STANDARD STOREFRONT) HORIZONTAL FRAMES SHALL BE PLACED AT 30" AND 96" ABOVE FINISHED FLOOR.  
CONTRACTOR SHALL PLACE BLACK TINTED GLASS PANELS IN BOTH 24" H x 60" W "UPPER" SECTIONS AS THIS AREA WILL BE ABOVE NEW SUSPENDED CEILING GRID. LOWER SECTIONS SHALL RECEIVE CLASS OF A SIMILAR TYPE AS EXISTING STOREFRONT PANELS.
- INSTALL NEW ACCESSIBLE WATER CLOSETS WITH 1 1/2" DIA. STAINLESS STEEL GRAB-BARS ALONG AND BEHIND NEW TOILETS. SIDE BARS SHALL BE 42" LONG (BEGINNING AT 12" FROM REAR WALL). REAR BARS SHALL BE 36" LONG. BARS SHALL BE MOUNTED TO WALL AT 34" A.F.F. AND SHALL SUPPORT A MINIMUM LOAD OF 250 LBS. EACH. NEW WALL HUNG LAVATORIES, EQUIPPED WITH SINGLE LEVER FAUCETS, SHALL BE MOUNTED TO WALL WITH A MINIMUM CLEARANCE OF 29" BETWEEN FLOOR AND FRONT BOTTOM EDGE OF FIXTURES. INSTALL A ROLL TOILET PAPER DISPENSER ON WALL ADJACENT TO EACH WATER CLOSET AT 22" A.F.F.  
INSTALL A 24" WIDE x 36" HIGH MIRROR PANEL ON WALL ABOVE EACH WALL HUNG SINK (BOTTOM OF PANELS TO BE 40" A.F.F.)
- INSTALL A NEW ELECTRICAL DISTRIBUTION PANEL ON THIS CONCRETE TILT-WALL PANEL. PROVIDE AND INSTALL A 48"x48"x3/4" PLYWOOD TELEPHONE EQUIPMENT BOARD ADJACENT TO ELEC. PANEL.  
TOP OF BOARD SHALL BE NO HIGHER THAN 84" A.F.F.  
POSITION THE DEDICATED 110V OUTLET AT BOTTOM EDGE OF EQUIP. BRD.
- INSTALL A SINGLE CYLINDER LOCK ON ACTIVE LEAF, WITH KEY CIL. ON WAREHOUSE SIDE OF DOOR.
- INSTALL SURFACE MOUNTED MECHANICAL DOCK LEVELERS AND DOCK SHELTER ON THESE TWO DOORWAYS.
- WIDEN EXISTING 8' WIDE OPENING TO 8'-6" AND REPLACE EXISTING OVERHEAD DOOR WITH NEW WIDER DOOR. NEW DOOR TO MATCH EXISTING DOORS FOR STYLE & FINISH.
- INSTALL A NEW 8" HIGH GALV. CHAIN-LINK (TOPPED WITH THREE STRANDS OF BARBED WIRE) FENCING SHALL BE SUPPORTED BY 3" DIA. GALV PIPE STANDARDS PLACED AT NO MORE THAN 8' O.C. INSTALL AN 8' HIGH x 10' WIDE HORIZONTALLY SLIDING CHAIN-LINK GATE AT THE CENTER OF THIS ENCLOSED AREA.
- INSTALL A 12"W x 18"H x 1/4" T FIXED GLASS INSERT IN THIS DOOR. POSITION TOP OF INSERT AT 70" A.F.F.

- CONSTRUCT A NEW STEEL REINFORCED CONCRETE RAMP AT THIS OVERHEAD DOOR OPENING.  
RAMP SHALL BE 10' LONG WITH A LEVEL VEHICLE LANDING OF 20' LONG  
RAMP SHALL BE 11' WIDE WITH 6" WIDE CURBS ALONG EACH SIDE.

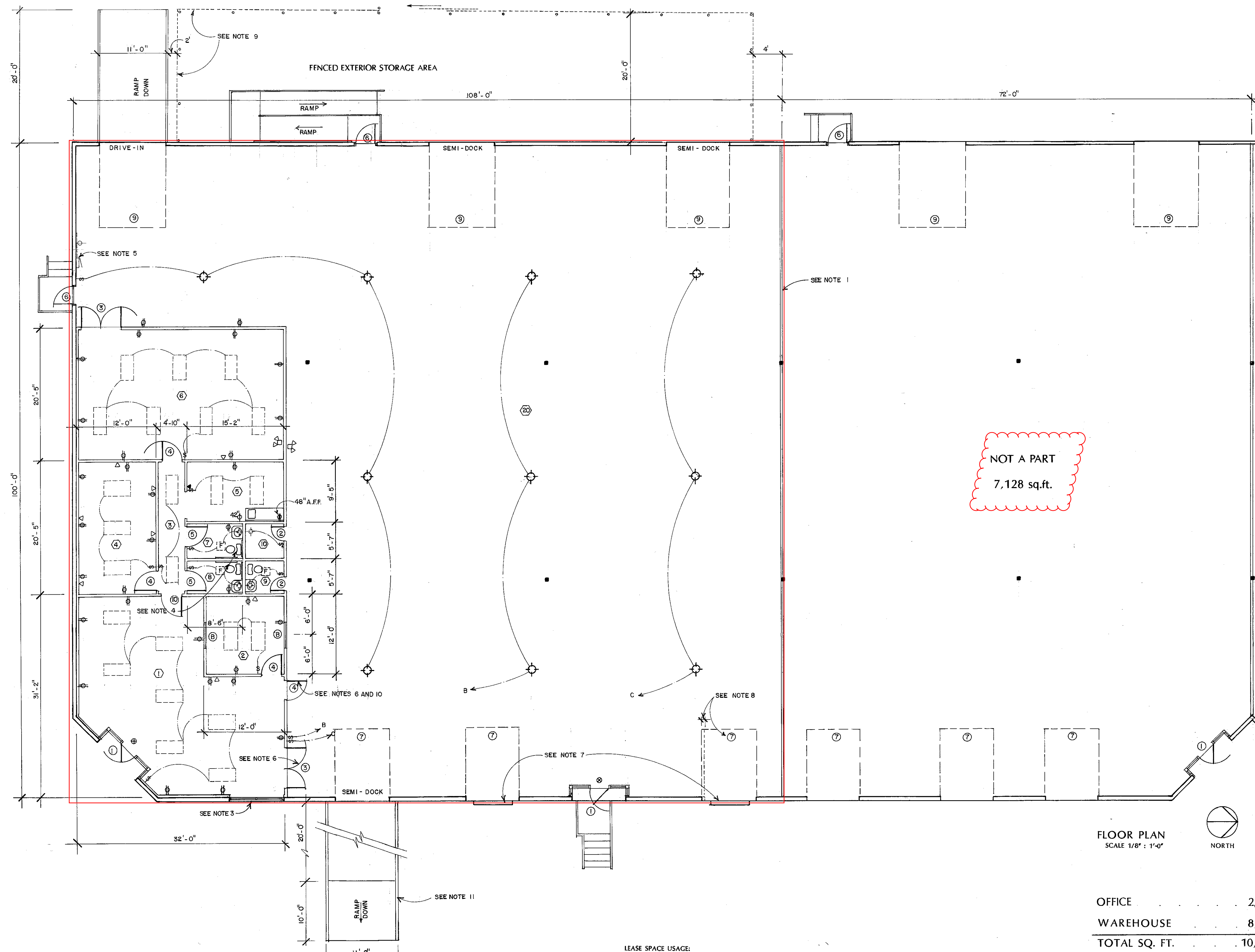

NOT A PART  
7,128 sq.ft.

FLOOR PLAN  
SCALE 1/8" = 1'-0"

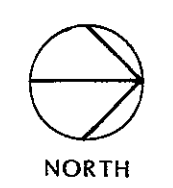

OFFICE	2,200
WAREHOUSE	8,528
<b>TOTAL SQ. FT.</b>	<b>10,728</b>

LEASE SPACE USAGE:

**SYMBOL KEY**

[Symbol]	FOUR TUBE, FLUORESCENT LIGHTING FIXTURE WITH STD. DIFFUSER (160W)
[Symbol]	TWO TUBE, FLUORESCENT LIGHTING FIXTURE, WAREHOUSE TYPE (160W)
[Symbol]	110V/20A DEDICATED DUPLEX ELECTRICAL OUTLET (ISOLATED WHEN NOTED)
[Symbol]	110V/20A DUPLEX ELECTRICAL OUTLET
[Symbol]	208V/30A DEDICATED ELECTRICAL OUTLET, SINGLE PHASE (UNLESS NOTED)
[Symbol]	WALL SWITCH ( 3 THREE WAY SWITCH)
[Symbol]	INCANDESCENT LIGHTING FIXTURE - RECESSED
[Symbol]	INCANDESCENT LIGHTING FIXTURE - SURFACE MOUNTED (WALL/CEILING)
[Symbol]	EMERGENCY LIGHTING (BATTERY POWERED)
[Symbol]	LIGHTED EXIT SIGN
[Symbol]	EXHAUST FAN MOUNTED IN CEILING GRID
[Symbol]	TELEPHONE "PULL-WIRE", STD. 1' A.F.F. / WALL PHONE AT 5' A.F.F.
[Symbol]	CIRCUIT BREAKER PANEL
[Symbol]	110V WATER HEATER AND PLATFORM (6 GALLON CAPACITY OR AS SPECIFIED)
[Symbol]	SPACE HEATER (GAS)
[Symbol]	NEW 400W METAL HALIDE FIXTURE WITH METAL REFLECTOR

**SPECIFICATIONS**

**GENERAL CONDITIONS:**  
DIVISIVE PARTITIONS: 1/2" GYP. BOARD ON 3 5/8" 25 GAUGE METAL STUDS AT 24" O.C. (FROM FLOOR TO BUILDING ROOF STRUCTURE)  
ENTRY: ALUMINUM & GLASS STOREFRONT WITH DOOR (STEPS & LANDINGS AS REQUIRED)  
OFFICE (UNLESS OTHERWISE NOTED)  
FLOORS: 3/32" VINYL TILE OR CARPET, GLUED DIRECTLY TO SLAB  
WALLS: 1/2" GYPSUM BOARD ON 2 1/2" MTL. STUDS AT 24" O.C. WITH 2 1/2" VINYL COVE BASE (WALL SHALL BE VINYL COVERED OR PAINTED)  
CEILINGS: 2'x 4' SUSPENDED 5/8" ACOUSTICAL TILE WITH 6" BATT INSULATION ABOVE

**WAREHOUSE:**  
FLOORS: FINISHED CONCRETE (UNLESS OTHERWISE NOTED)  
WALLS: EXPOSED CONCRETE OR UNFINISHED GYPSUM BOARD (SEE NOTE 1 BELOW)  
CEILING: EXPOSED STEEL FRAMING AND ROOF DECKING

**SPECIAL NOTES:**  
1) ALL DIVISIVE PARTITIONS ARE NON-LOAD BEARING AND WILL NOT SUPPORT HORIZONTAL OR VERTICAL LOADS.  
2) ALL EXTERIOR LIGHTING (SWITCH-LEGGED "A") SHALL BE ACTIVATED BY PHOTOCELL, AND SHALL BE SUPPLIED FROM TENANT'S MAIN BREAKER PANEL.  
3) ALL DIMENSIONS ARE SUBJECT TO CHANGE DUE TO EXISTING CONDITIONS.

**ROOM FINISH SCHEDULE**

#	NAME	FLR.	CLG.	WALLS	HVAC	LEGEND OF FINISHES
(1)	OPEN OFFICE	A	M	G	O	A. CARPET (1)
(2)	OFFICE	A				B. V.C. TILE (1)
(3)	HALLWAY	A				C. FINISHED CONCRETE
(4)	OFFICE	A				D. SEALED CONCRETE
(5)	BREAK ROOM	B				E. VINYL COVERED GYP. BOARD
(6)	CONFERENCE ROOM	A				F. JOB APPLIED WALL COVERING
(7)	MEN	B				G. TAPE, FLOAT, & PAINT
(8)	WOMEN	B				H. UNFINISHED GYPSUM BOARD
(9)	WHSE. TOILET	B				K. OPEN TO ROOF DECKING
(10)	CLOSET	B	V	V	V	L. 8'-0" CLEAR HEIGHT
(11)						M. 9'-0" CLEAR HEIGHT
(12)						N.
(13)						O. AIR CONDITIONED
(14)						P. NON-AIR CONDITIONED
(15)						
(16)						
(17)						
(18)						
(19)						
(20)	WAREHOUSE	C	K	H	P	

CARPET: (1)  
V.C. TILE: (1) AZROCK  
COUNTER TOP LAMINATE: FORMICA  
VINYL COVERED GYP. BOARD: DURASAN  
PAINT:

**DOOR AND WINDOW SCHEDULE**

SYM.	DIMENSIONS	DESCRIPTION	LOCK	REMARKS
(1)	3'-0" x 7'-0" x 1 3/4"	ALUMINUM & GLASS DOOR	DEADBOLT	
(2)	2'-0" x 6'-8" x 1 3/8"	H.C. PREFINISHED DOOR	PRIVACY	
(3)	PR. 3'-0" x 6'-8" x 1 3/4"	H.C. PREFINISHED DOOR	PRIVACY	
(4)	2'-0" x 6'-8" x 1 3/8"	H.C. PREFINISHED DOOR	PRIVACY	
(5)	3'-0" x 6'-8" x 1 3/8"	H.C. PREFINISHED DOOR		
(6)	3'-0" x 7'-0" x 1 3/4"	H.C. MTL. "PERSONNEL" DOOR	DEADBOLT	
(7)	8'-0" x 10'-0"	OVERHEAD DOOR		
(8)	10'-0" x 10'-0"	OVERHEAD DOOR		
(9)	10'-0" x 12'-0"	OVERHEAD DOOR		
(10)	3'-0" x 6'-8" x 1 3/4"	H.C. PREFINISHED DOOR	SINGLE CYL. LOCK KEYPED FROM HALLWAY	
(A)	3'-0" x 4'-0" x 1/4"	ALUMINUM & GLASS WINDOW		HORIZONTAL SLIDING
(B)	3'-0" x 4'-0" x 1/4"	ALUMINUM & GLASS WINDOW		FIXED PANEL
(C)	2'-0" x 9'-0" x 1/4"	ALUMINUM & GLASS WINDOW		FIXED PANEL
(D)				

**HVAC**  
THE HEATING, VENTILATION, AND AIR CONDITIONING SYSTEM FOR THIS SPACE WAS DESIGNED FOR: A MAXIMUM PERSONNEL LOAD OF 22 PEOPLE, A MAXIMUM LIGHTING LOAD OF 3900 WATTS, AND TO MAINTAIN AN INSIDE TEMPERATURE OF 78° FROM 100° OUTSIDE AIR WITH 50% RELATIVE HUMIDITY. AN ADDITIONAL HEAT LOAD OF -0- BTU FROM EQUIPMENT HAS BEEN CONSIDERED IN THIS SYSTEM. THE SYSTEM CONSISTS OF: ONE 7.5 TON ROOF TOP CAS/ELEC.

**Grubb & Ellis**  
Property Solutions Worldwide™  
1335 N.E. LOOP 410 SAN ANTONIO, TEXAS 78216 (512) 828-9050

**EXHIBIT "D"**  
A PROPOSED FACILITY FOR  
**LENNOX**

PROJECT: RE #28 ADDRESS:  
PLAN DATE: 29 JUNE 2001 OCCUPANCY DATE:  
LANDLORD: TENANT:

NOTE: ALL CHANGES MADE AFTER SIGNING THIS DRAWING ARE AT TENANT'S EXPENSE.